

2

1

S.No.	COLOR
1	WHITE
2	SILVER
3	BRONZE
4	BLACK

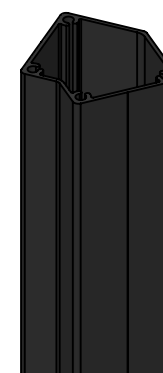
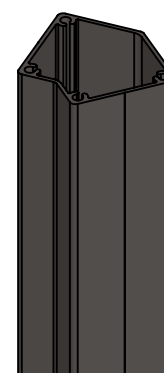
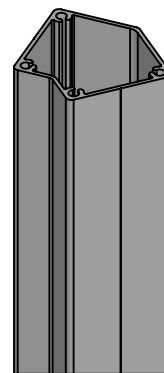
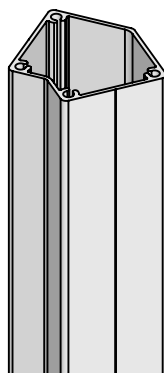

① WHITE

② SILVER

③ BRONZE

④ BLACK

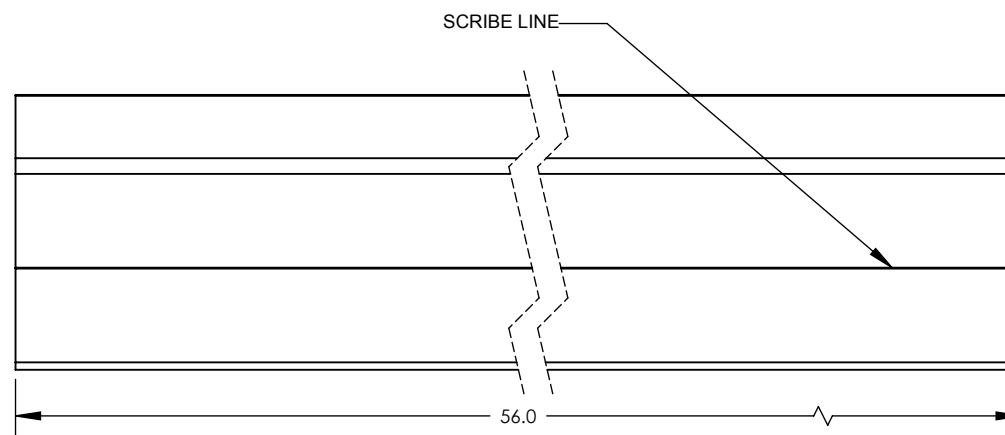
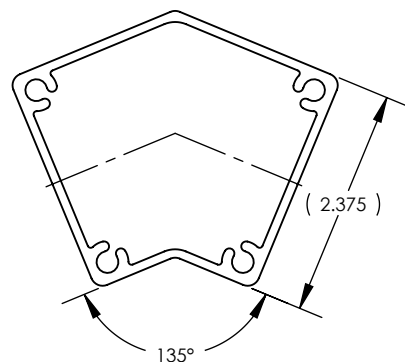

PART IS MADE FROM "AADF-AP-00" EXTRUSION

eGlass Element™
eGlass Solid™
eGlass Vision™
eGlass Picket™

PROPRIETARY AND CONFIDENTIAL

THE INFORMATION CONTAINED IN THIS DRAWING IS THE
SOLE PROPERTY OF EGLASS LLC.
ANY REPRODUCTION IN PART OR AS A WHOLE WITHOUT
THE WRITTEN PERMISSION OF EGLASS LLC
IS PROHIBITED.

NOTES: UNLESS OTHERWISE SPECIFIED

- DIMENSIONS SHOWN - INCHES [MM].
- MACHINED SURFACES TO BE 63μIN MAX.
- PART TO BE FREE OF BURRS AND SHARP EDGES.
- ALL MATERIAL TO BE CLEAN, DEGREASED AND FREE OF ALL IMPURITIES.
- ANY CHANGE MUST BE AUTHORIZED BY AN EGLASS ENGINEER.

DIMENSIONS ARE IN INCHES
FRACTIONAL ±
ANGULAR: MACH ±
TWO PLACE DECIMAL ±
THREE PLACE DECIMAL ±

MATERIAL

AL 6063-T6

FINISH

AAMA 2605 POWDER COAT

DO NOT SCALE DRAWING

	NAME	DATE
DRAWN	V.P.	09/11/18
ENG APPR.		
MFG APPR.		

COMMENTS:

PURCHASER HAS THE FULL RESPONSIBILITY TO
COMPLY WITH LOCAL, NATIONAL AND
INTERNATIONAL BUILDING CODES. PURCHASER
SHALL COMPLY IN ALL RESPECTS WITH ALL
APPLICABLE LEGAL REQUIREMENTS GOVERNING
THE DUTIES, OBLIGATIONS, AND BUSINESS
PRACTICES OF THEIR LOCALITIES AND SHALL
OBTAIN ANY PERMITS OR LICENSES NECESSARY
FOR THEIR OPERATIONS.

eGLASS
RAILING™

TITLE:

135° POST, 56" LENGTH

SIZE

DWG. NO.

REV

A

AAAA-AP-56

7

SCALE: 1:2

WEIGHT: 6.150 Lbs

SHEET 1 OF 1

2

1