

Phone/Fax: 800-545-1275

Email: sales@eglassrailing.com

Website: <https://www.eglassrailing.com>

Address: 4055 S Grant St.
Washougal, WA 98671

Installation Instructions For eGlass® Vision™

Assembly & Installation Steps:

1. Installation Preparation (p.2)
2. Review Railing Components (p.4)
3. Review the Drill Guide (p.8)
4. Install Deck Mount Posts (p.8-9)
5. Install Fascia Mount Posts (p.10-12)
6. Pre-Drill Clamp Locations (p.13)
7. Attach Clamps to Posts (p.13)
8. Install Glass Panels (p.13)
9. Drill Weep Holes (p.14)
10. Install Post Caps (p.14)
11. Care & Maintenance (p.14)

eGlass® Vision™ Mounting Options

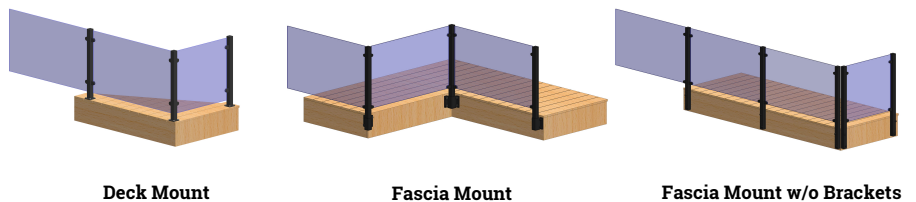

eGlass® Vision™ Stair Options

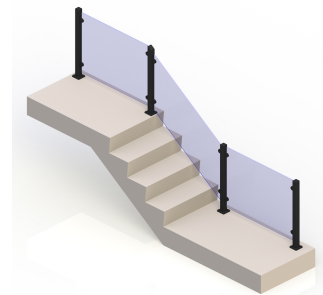

Stair Transition with Glass

Purchaser has the full responsibility to comply with local, national, and international building codes. Purchaser shall comply in all respects with all applicable legal requirements governing the duties, obligations, and business practices of their localities and shall obtain any permits or licenses necessary for their operations. In no event shall eGlass LLC be liable for any direct, indirect, punitive, incidental, special, or consequential damages, to property or life, whatsoever arising out of or connected with the use or misuse of our products. Purchaser shall not take any action in violation of any applicable legal requirement that could result in liability being imposed on eGlass LLC. Any liability imposed by eGlass LLC shall be limited to the amount of insurance carried by eGlass LLC that may be applicable to such claims as may arise.

eGlass railing system components meet all building guidelines for structural strength and usability and can easily be assembled on-site. The railing system components are made of aluminum, providing a long-term low maintenance system.

Installation Instructions For eGlass® Vision™

It is the responsibility of the installer to meet and/or exceed all code and safety requirements and to obtain all required building permits. The deck and railing installer should determine and implement appropriate installation techniques for each installation.

Refer to www.eglassrailing.com to ensure that you are viewing the most recent installation instructions.

Step 1: Installation Preparation

- Match all components to the packing slip and inspect to ensure none are missing or damaged.
- Gather recommended tools and supplies.
- Measure twice before cutting any component.



Tools Needed

- Safety glasses
- Ear protection
- Gloves
- Measuring tape
- Felt tip marker
- Chop saw
- Level
- Small file
- Electric drill
- Drive bits
- Drill bits
- Dead blow hammer
- Painter's tape
- Screw driver kit
- Foam glass cleaner
- Touch up paint

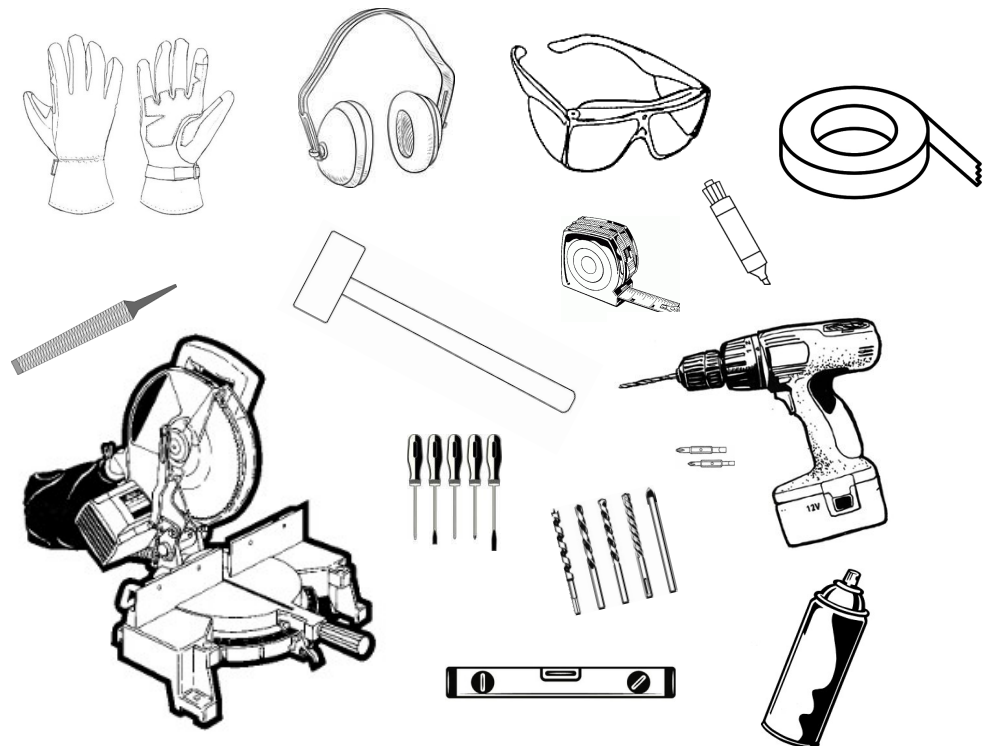

Installation Instructions For eGlass® Vision™

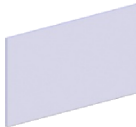
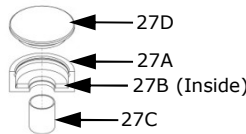
 32.5" Height <table><tr><th>Width</th><th>ITEM No.</th></tr><tr><td>7.625"</td><td>RAAF-G3-08</td></tr><tr><td>11.625"</td><td>RAAF-G3-12</td></tr><tr><td>15.625"</td><td>RAAF-G3-16</td></tr><tr><td>19.625"</td><td>RAAF-G3-20</td></tr><tr><td>23.625"</td><td>RAAF-G3-24</td></tr><tr><td>27.625"</td><td>RAAF-G3-28</td></tr><tr><td>31.625"</td><td>RAAF-G3-32</td></tr><tr><td>35.625"</td><td>RAAF-G3-36</td></tr><tr><td>39.625"</td><td>RAAF-G3-40</td></tr><tr><td>43.625"</td><td>RAAF-G3-44</td></tr><tr><td>45.125"</td><td>RAAF-G3-45</td></tr><tr><td>46.625"</td><td>RAAF-G3-47</td></tr><tr><td>48.125"</td><td>RAAF-G3-48</td></tr><tr><td>49.625"</td><td>RAAF-G3-50</td></tr><tr><td>51.125"</td><td>RAAF-G3-51</td></tr><tr><td>52.625"</td><td>RAAF-G3-53</td></tr><tr><td>54.125"</td><td>RAAF-G3-54</td></tr><tr><td>55.625"</td><td>RAAF-G3-56</td></tr></table> 38.5" Height <table><tr><th>Width</th><th>ITEM No.</th></tr><tr><td>7.625"</td><td>CAAF-G3-08</td></tr><tr><td>11.625"</td><td>CAAF-G3-12</td></tr><tr><td>15.625"</td><td>CAAF-G3-16</td></tr><tr><td>19.625"</td><td>CAAF-G3-20</td></tr><tr><td>23.625"</td><td>CAAF-G3-24</td></tr><tr><td>27.625"</td><td>CAAF-G3-28</td></tr><tr><td>31.625"</td><td>CAAF-G3-32</td></tr><tr><td>35.625"</td><td>CAAF-G3-36</td></tr><tr><td>39.625"</td><td>CAAF-G3-40</td></tr><tr><td>43.625"</td><td>CAAF-G3-44</td></tr><tr><td>45.125"</td><td>CAAF-G3-45</td></tr><tr><td>46.625"</td><td>CAAF-G3-47</td></tr><tr><td>48.125"</td><td>CAAF-G3-48</td></tr><tr><td>49.625"</td><td>CAAF-G3-50</td></tr><tr><td>51.125"</td><td>CAAF-G3-51</td></tr><tr><td>52.625"</td><td>CAAF-G3-53</td></tr><tr><td>54.125"</td><td>CAAF-G3-54</td></tr><tr><td>55.625"</td><td>CAAF-G3-56</td></tr></table>	Width	ITEM No.	7.625"	RAAF-G3-08	11.625"	RAAF-G3-12	15.625"	RAAF-G3-16	19.625"	RAAF-G3-20	23.625"	RAAF-G3-24	27.625"	RAAF-G3-28	31.625"	RAAF-G3-32	35.625"	RAAF-G3-36	39.625"	RAAF-G3-40	43.625"	RAAF-G3-44	45.125"	RAAF-G3-45	46.625"	RAAF-G3-47	48.125"	RAAF-G3-48	49.625"	RAAF-G3-50	51.125"	RAAF-G3-51	52.625"	RAAF-G3-53	54.125"	RAAF-G3-54	55.625"	RAAF-G3-56	Width	ITEM No.	7.625"	CAAF-G3-08	11.625"	CAAF-G3-12	15.625"	CAAF-G3-16	19.625"	CAAF-G3-20	23.625"	CAAF-G3-24	27.625"	CAAF-G3-28	31.625"	CAAF-G3-32	35.625"	CAAF-G3-36	39.625"	CAAF-G3-40	43.625"	CAAF-G3-44	45.125"	CAAF-G3-45	46.625"	CAAF-G3-47	48.125"	CAAF-G3-48	49.625"	CAAF-G3-50	51.125"	CAAF-G3-51	52.625"	CAAF-G3-53	54.125"	CAAF-G3-54	55.625"	CAAF-G3-56	① 3/8" Tempered Glass Panels (3/8" Glass Thk.)	② Square Post ITEM No. RADF-SP-36 AAAA-SP-48 AAFA-SP-56 <i>Trim as needed</i>	③ 135-Deg Post ITEM No. AADF-AP-36 AADF-AP-48 AAAA-AP-56 <i>Trim as needed</i>	④ Post Cap ITEM No. AAAA-PC-01
Width	ITEM No.																																																																															
7.625"	RAAF-G3-08																																																																															
11.625"	RAAF-G3-12																																																																															
15.625"	RAAF-G3-16																																																																															
19.625"	RAAF-G3-20																																																																															
23.625"	RAAF-G3-24																																																																															
27.625"	RAAF-G3-28																																																																															
31.625"	RAAF-G3-32																																																																															
35.625"	RAAF-G3-36																																																																															
39.625"	RAAF-G3-40																																																																															
43.625"	RAAF-G3-44																																																																															
45.125"	RAAF-G3-45																																																																															
46.625"	RAAF-G3-47																																																																															
48.125"	RAAF-G3-48																																																																															
49.625"	RAAF-G3-50																																																																															
51.125"	RAAF-G3-51																																																																															
52.625"	RAAF-G3-53																																																																															
54.125"	RAAF-G3-54																																																																															
55.625"	RAAF-G3-56																																																																															
Width	ITEM No.																																																																															
7.625"	CAAF-G3-08																																																																															
11.625"	CAAF-G3-12																																																																															
15.625"	CAAF-G3-16																																																																															
19.625"	CAAF-G3-20																																																																															
23.625"	CAAF-G3-24																																																																															
27.625"	CAAF-G3-28																																																																															
31.625"	CAAF-G3-32																																																																															
35.625"	CAAF-G3-36																																																																															
39.625"	CAAF-G3-40																																																																															
43.625"	CAAF-G3-44																																																																															
45.125"	CAAF-G3-45																																																																															
46.625"	CAAF-G3-47																																																																															
48.125"	CAAF-G3-48																																																																															
49.625"	CAAF-G3-50																																																																															
51.125"	CAAF-G3-51																																																																															
52.625"	CAAF-G3-53																																																																															
54.125"	CAAF-G3-54																																																																															
55.625"	CAAF-G3-56																																																																															
		⑤ 135-Degree Post Cap ITEM No. AAAA-CA-01	⑥ Glass Clip (Round) ITEM No. AAVA-GC-00	⑦ Glass Clip (Square) ITEM No. AAVA-GC-20																																																																												
		⑧ 1/4" - 20 x 1" Phil Pan TYF 410SS ITEM No. STD-SC-07	⑨ 1.5" Lag Socket Screw ITEM No. STD-SC-21	⑩ 3/8" Thru Bolt ITEM No. STD-HB-375 STD-HBME-375																																																																												
⑪ 3/8" Lag Screw ITEM No. STD-HB-375 STD-HBME-375	⑫ Clamp Install Kit ITEM No. PACK-GC-01 PACK-GC-02	⑬ Base Plate Shim Kit ITEM No. PACK-SK-01	⑭ 3/8" Screw Cover ITEM No. STD-SW-00																																																																													
⑮ Drill Guide ITEM No. RAAF-DG-01																																																																																
Deck Mount Only:																																																																																
⑯ Base Plate ITEM No. RADA-BP-01	⑰ 135-Degree Base Plate ITEM No. AADF-BA-01	⑱ Base Plate Pad ITEM No. RADA-PD-01	⑲ 135-Deg Base Plate Pad ITEM No. AAAA-BR-01	⑳ 1/4" - 20 x 1.75" FH TF Screw ITEM No. STD-SC-05B																																																																												
Fascia Mount Only:																																																																																
㉑ Intermediate Bracket ITEM No. AAGA-IB-01	㉒ Outside Corner Bracket ITEM No. AAGA-OC-01	㉓ Inside Corner Bracket ITEM No. AAGA-IC-01	㉔ Intermediate Bottom Cap ITEM No. AAGA-BC-01	㉕ Outside Corner Cap ITEM No. AAGA-BC-02	㉖ Inside Corner Cap ITEM No. AAGA-BC-03																																																																											
㉗ Intermediate Shim ITEM No. AAGA-SH-01	㉘ Corner Shim ITEM No. AAGA-SH-02	㉙ Intermediate Gasket ITEM No. AAGA-NG-01	㉚ Corner Gasket ITEM No. AAGA-NG-02	㉛ 1/4" - 20 x 1" Flat Head TF Screw ITEM No. STD-SC-04	㉜ #12 x 1" Flat Head Screw ITEM No. STD-SC-09																																																																											

Installation Instructions For eGlass® Vision™

Step 2: Review Railing Components

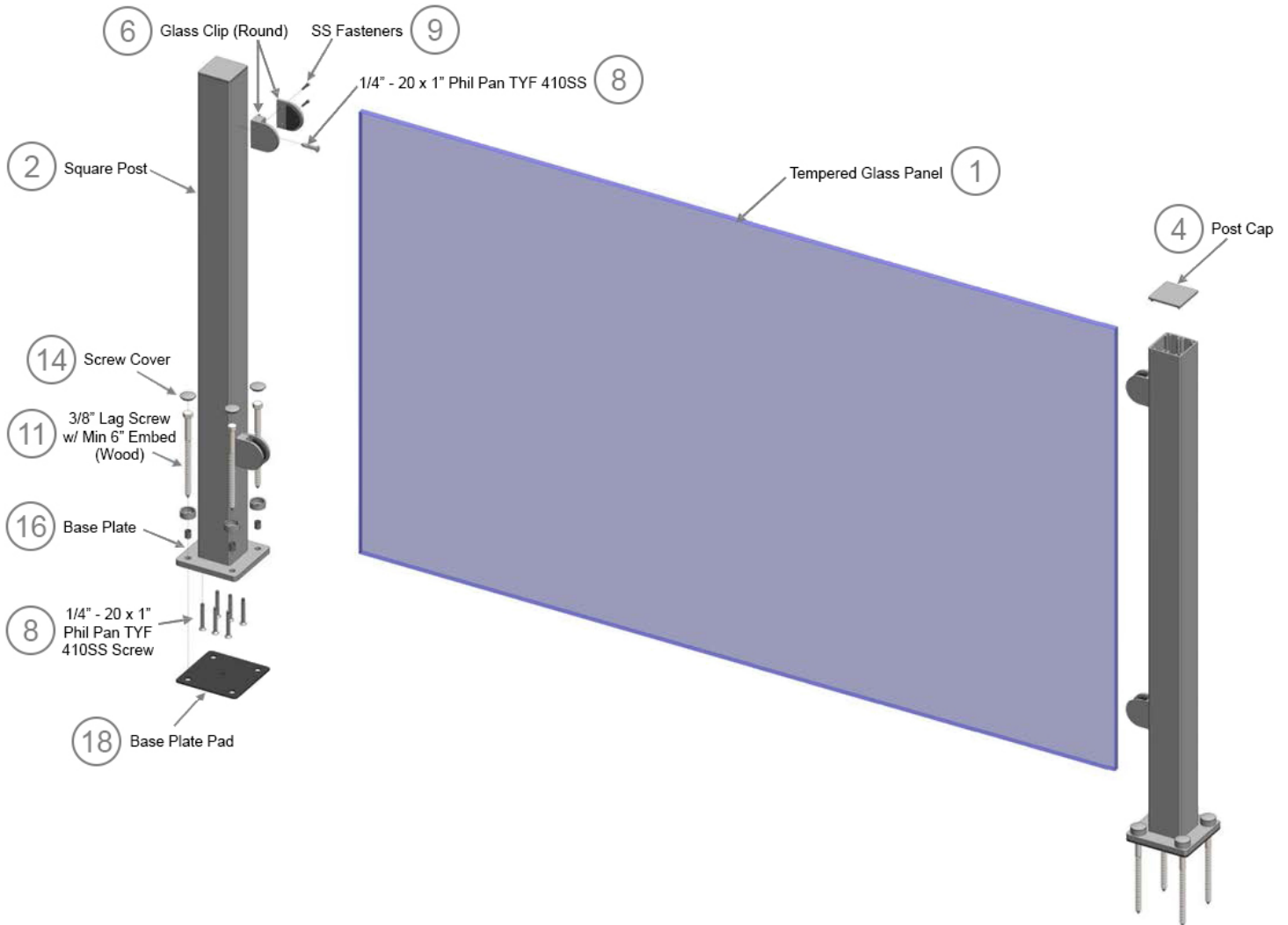

Installation Instructions For eGlass® Vision™

**Round Glass Clip Connection
(Option-1)**

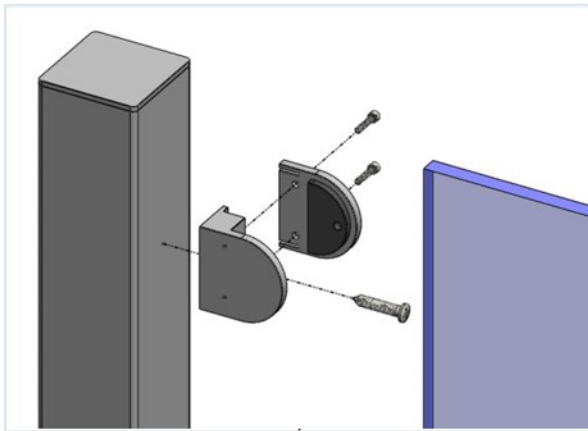

**Square Glass Clip Connection
(Option-2)**

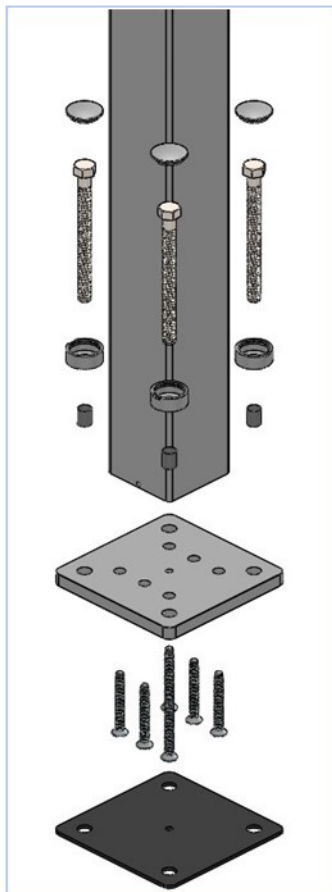
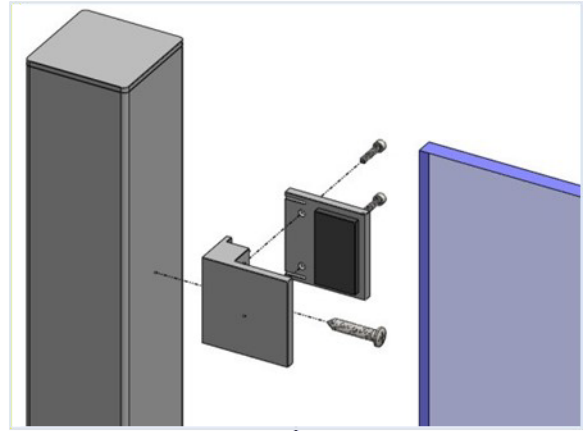

Deck Mounting Connection

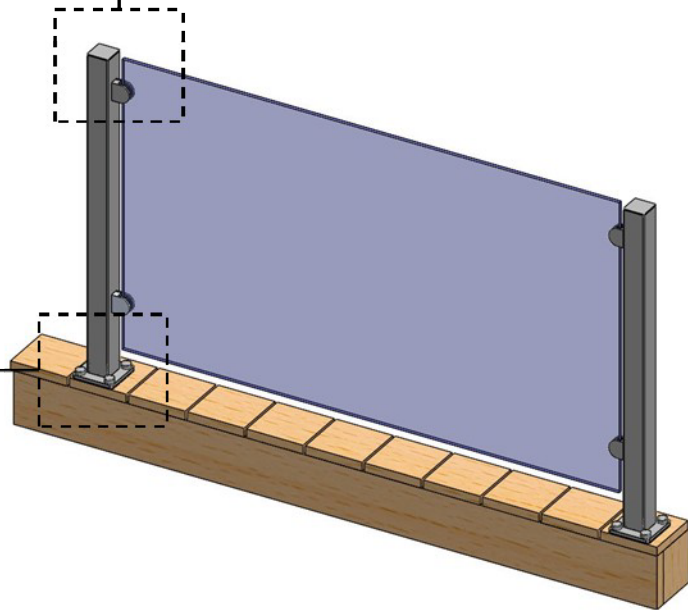

Installation Instructions For eGlass® Vision™

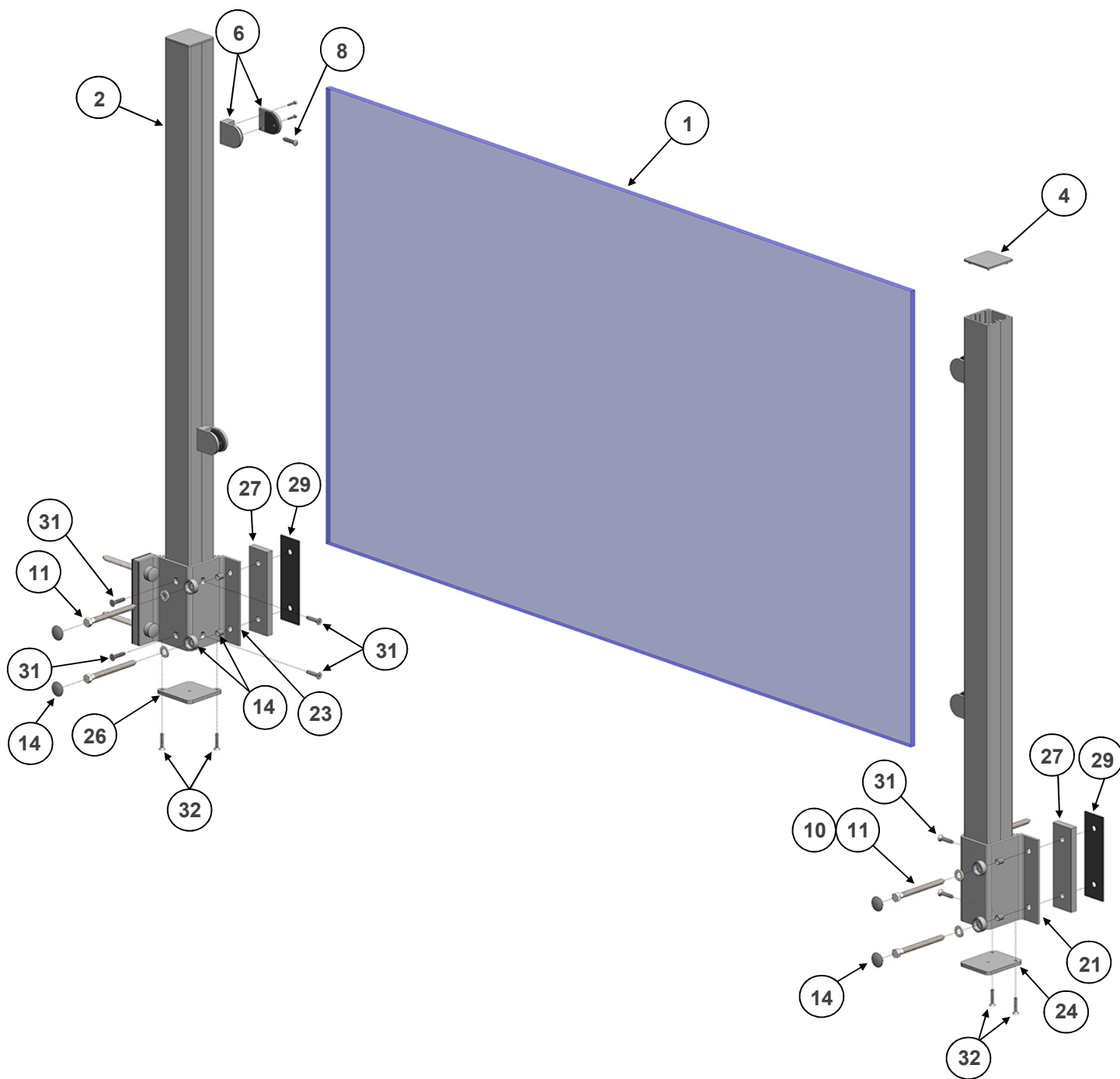

Installation Instructions For eGlass® Vision™

**Round Glass Clip Connection
(Option-1)**

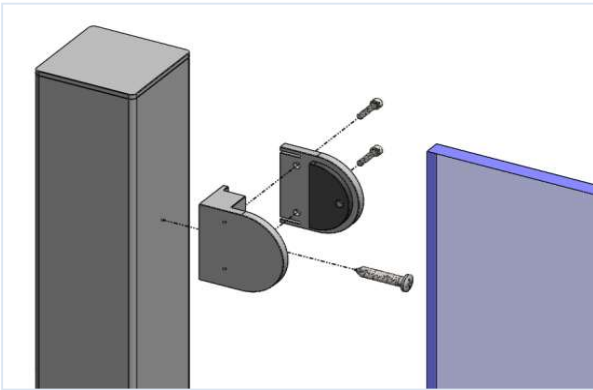

**Square Glass Clip Connection
(Option-2)**

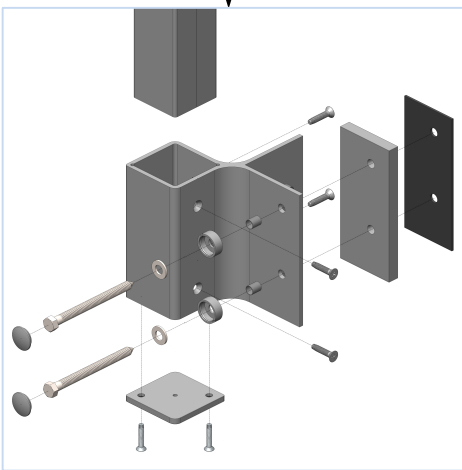
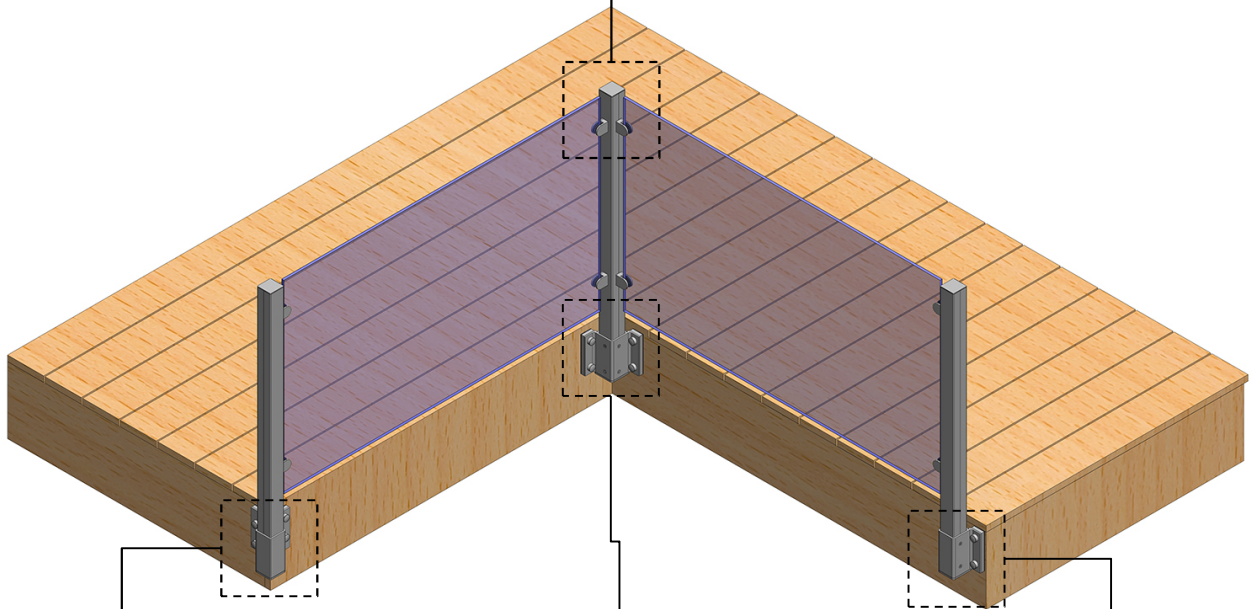
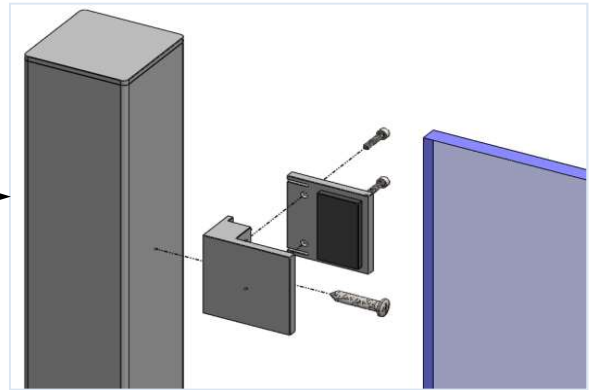

**Outside Corner Bracket
Connection**

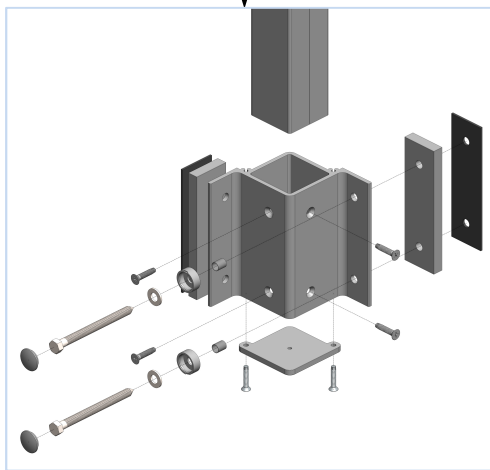

**Inside Corner Bracket
Connection**

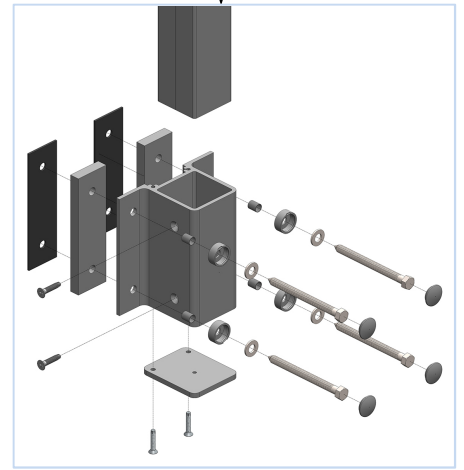

**Intermediate Bracket
Connection**

Installation Instructions For eGlass® Vision™

Step 3: Review the Drill Guide

Drill Guides (15) are meant to be used with all inline eGlass Railing™ Systems, therefore it is very important to pay attention to the notations on the drill guide to ensure you are cutting and drilling correctly.

NOTE: Deck Mount cutting notations are in **Blue**. Fascia Mount cutting notations are in **Red**.

The notched numbers on one end of the Drill Guide are color-coded depending on railing system and mounting style.

NOTE: The numbers are NOT in numerical Order.

NOTE: Do NOT use drill guides on stairs. Instead refer to your Customer Detail Form.

Step 4: Install Deck Mount Posts (SKIP IF SYSTEM IS FASCIA ONLY)

4A. Review Layout & Mark Deck

- Review your eGlass Installation Layout Detail to verify exact post placement for your project.
- Note the locations of deck ends and corners, as well as any other critical locations. Begin with the furthest corner from the house.
- Some shimming, additional framing, or blocking may be necessary to securely attach base plates or fascia brackets.
- Make sure to maintain a gap of not more than 4" anywhere in the railing.

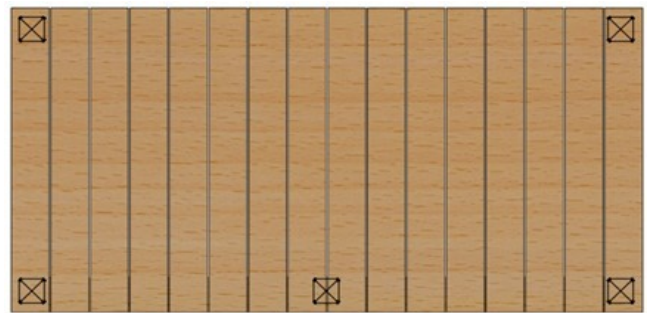

Fig 1

4B. Measure & Cut Deck Mount Posts

- Select a post blank (2) and identify the post type. If the post is for an inline run, select the appropriate Drill Guide (15) and follow the steps below. If the post is for a stair run, reference your Customer Detail Form instead to determine final cut height, then follow the steps below regarding post cutting and touch-up advice.

- Place the Drill Guide (15) on the post, as shown in Figure 2. Tape the Drill Guide to the post using painter's tape.

NOTE: Always use painter's tape. Other tapes may damage powder coat and/or leave sticky residue.

- Only use the Drill Guide on the scribe side of the post according to Figure 2.
- Use the drill guide instructions to mark the required height of the post.
Example: Drill Guide 1 represents post height for eGlass Vision™ (Fascia Mount).

- Cut the post according to the marking using a miter saw.

NOTE: We recommend a carbide-tipped blade with 60 teeth or more.

- Make sure your saw is set properly to ensure your cut is square.
- File cut end. Then use touch-up paint to protect the cut end from corrosion.

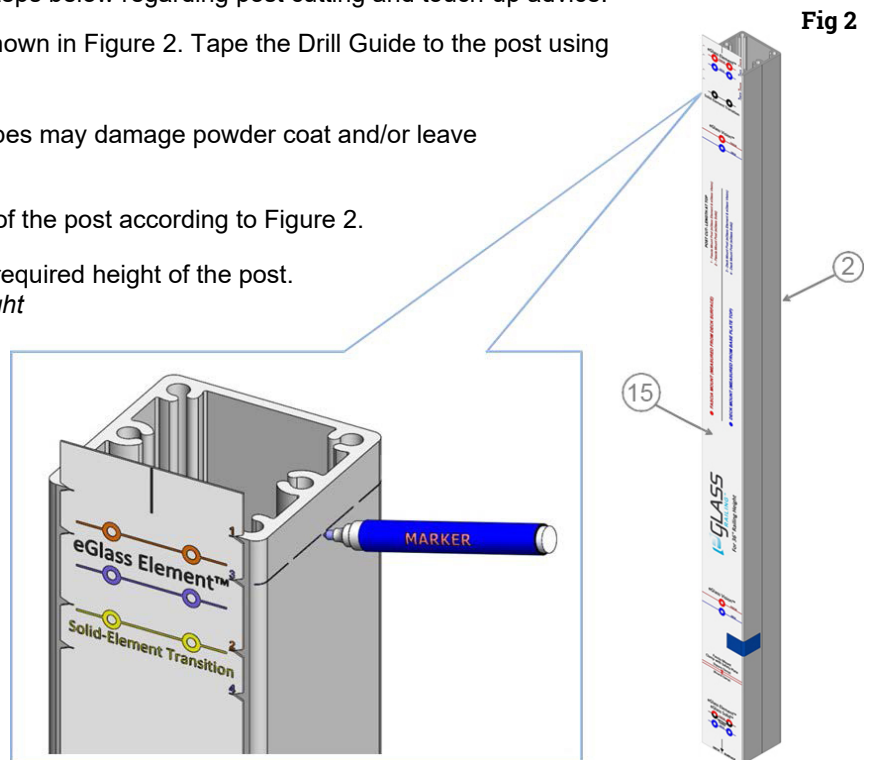

Fig 2

Installation Instructions For eGlass® Vision™

4C. Attach Base Plate to Post

- Turn the post (2) upside down on a hard surface and attach the base plate (25) to the post using six 1/4"-20 x 1.75" Flat Head TF Screws (20).
- Tighten the base plate firmly onto the post.

NOTE: An impact driver is recommended for this step.

4D. Attach Post Assembly to Deck

NOTE: Only install enough posts to install one glass panel at a time. This will ensure spacing between posts is correct for each pane of glass.

- Scribe line of post should always face inside.
- Make sure the six screw chase slots on each post are lined up parallel to the deck
- Square up the post with the deck surface and mark all four base plate holes with a marker.

NOTE: The outside mounting screws for the post base plates must be able to screw into the perimeter deck joist. Position post base plates far enough from the edge of the deck to enable this. Failure to screw into the deck joist will weaken the installation.

- Using the marks as a guide, pre-drill four holes for the anchor hardware (Refer to Fig 5 to ensure correct drill is used).
- Remove the backing from the base plate pad (18) and attach the pad to the base plate.

NOTE: Use painter's tape around the base of the post to protect it while using the drill.

- Place washer (14B) into screwbase (14A)

NOTE: Ensure that screw base slot faces outward so that caps can be removed.

- Place sleeve (14C) onto anchor hardware (10 or 11).
- Fasten the base plate to the deck using chosen hardware (10 or 11).
- Shim your post using base plate shim kit (13) as needed to ensure the post is plumb.

NOTE: Bolt torque can be varied in order to plumb post.

- Continue tightening the anchor bolt until the bead is firmly seated against the post base plate. Do not overtighten.

NOTE: Do not install screw cap covers (14D) until the rest of the railing install has been completed.

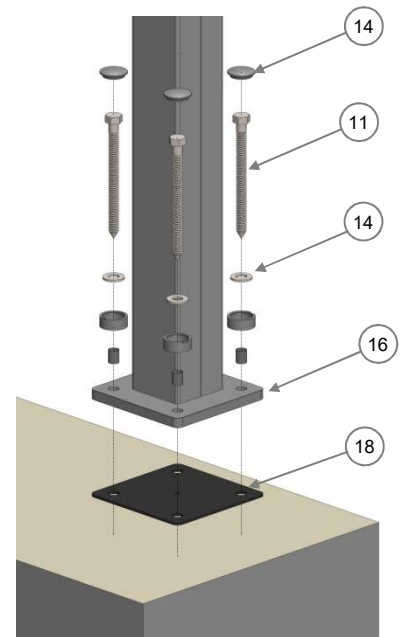
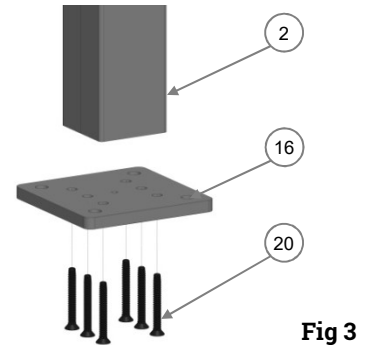

Fig 4

Repeat Step 4 for the entire deck.

Hardware Size	Post Hole Size	Pilot Hole (Wood)
3/8" Bolt	13/32"	13/32"
3/8" Lag	13/32"	1/4"
1/2" Bolt	17/32"	17/32"
1/2" Lag	17/32"	11/32"

Fig 5

Installation Instructions For eGlass® Vision™

Step 5: Install Fascia Mount Posts (SKIP IF SYSTEM IS DECK MOUNT ONLY)

5A. Review Layout & Mark Deck

Review the project layout drawings and note the locations of deck ends and corners as well as any other critical locations.

- Locate and mark center of an end post or corner post to start the railing installation.
- Make sure to maintain the gap not more than 4" between the post and wall.

5B. Mount Fascia Brackets

NOTE: Only install enough brackets to install one glass panel at a time. This will ensure spacing between posts is correct for each pane of glass.

- If you are not using fascia bracket shim stacks (27, 28), attach the rubber pads (29, 30) to your fascia brackets (21, 22, 23) prior to installation. If shim stacks are being used, attach the rubber pads to the shim stacks and place between the bracket and fascia board with the rubber pad facing the board.
- Prepare corner brackets (22, 23, 25, 26, 28, 30; if included). Place the bracket(s) at desired height (centered as typical) on fascia board and mark drill locations.
- Prepare inline brackets (21, 24, 27, 29):
 - Pre-mount post inside inline bracket using FH TF screws (31)
 - Place bracket at desired height (centered is typical) at the correct distance for correct post spacing. Mark one hole location, remove bracket, then drill hole.
 - See Fig 5 (previous page) for correct drill sizes.
 - Use mounting hardware to temporarily attach fascia bracket to deck through this hole. Using a level, rotate the bracket until the post is plumb. Mark drill locations for the other three holes.
 - Remove the bracket and drill pilot holes.
- Starting from corner or end of railing, mount fascia brackets according to the supplied customer installations layout.
 - Place the Shim Stacks (if used; 27, 28) and Neoprene Gaskets (29, 30) between the Fascia Brackets (21, 22, 23) and deck. Make sure you are using the right gaskets and shims for each fascia bracket type. Reference Fig 7 for assistance.
 - For inline brackets, place screw base (14A), washer (14B), sleeve (14C) before installing the mounting hardware (10, 11).
 - Continue tightening the anchor bolts until the heads are firmly seated against the bracket surface. Do not over tighten.

NOTE: Do not install bolt cover caps (14D) until the end of install. Bolt torque will be varied in a later step to further plumb posts.



Fig 6

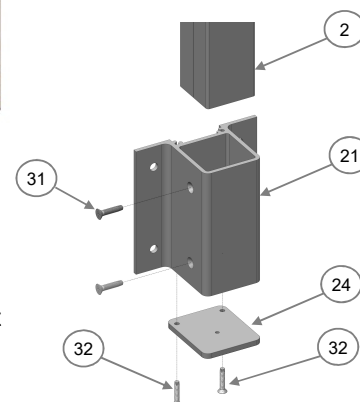

Intermediate bracket

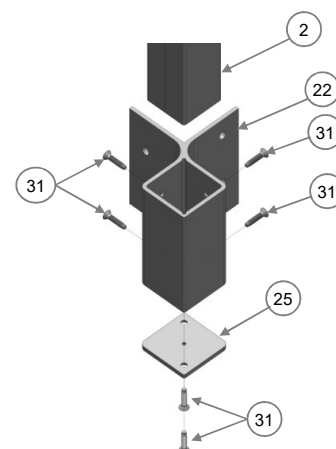

Outside Corner bracket

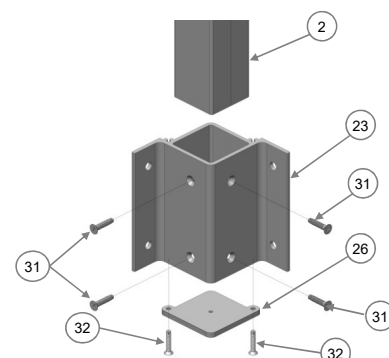
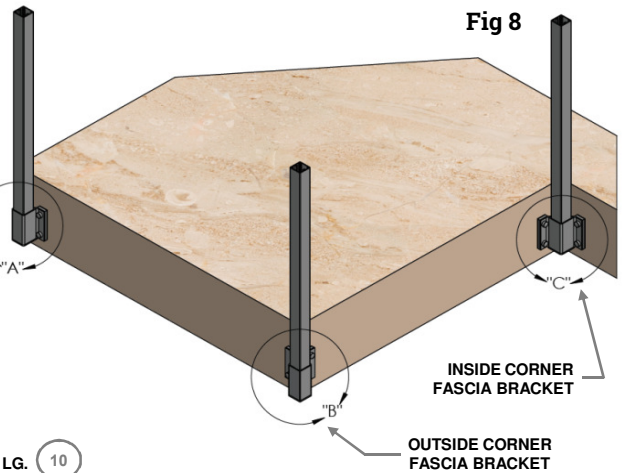
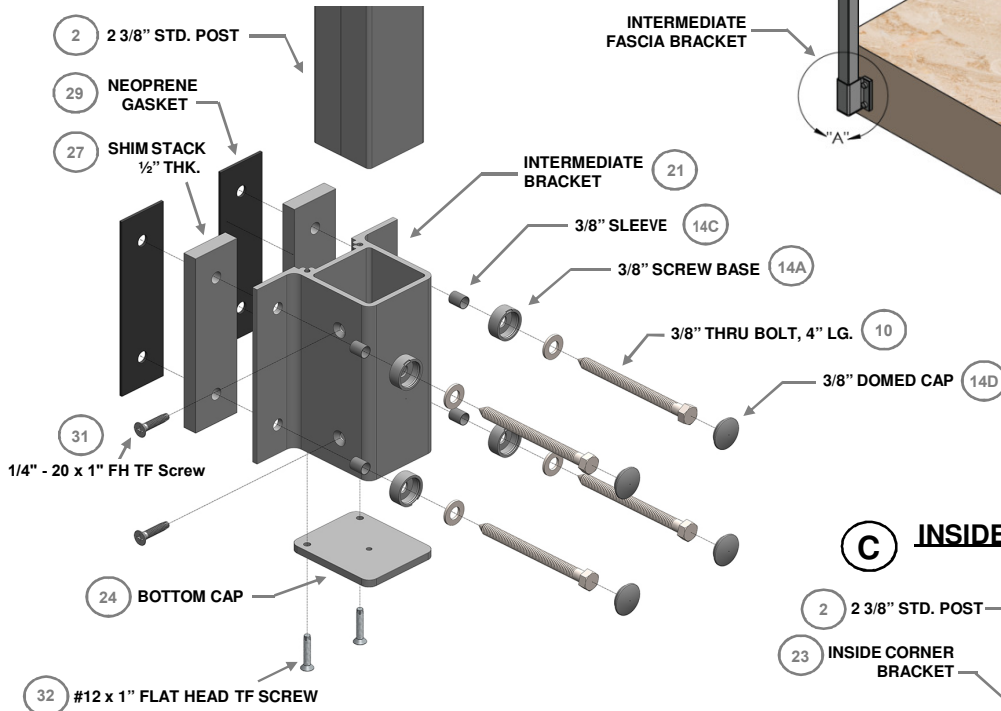

Fig 7 Inside Corner bracket

Installation Instructions For eGlass® Vision™

A INTERMEDIATE FASCIA BRACKET MOUNTING DETAIL



C INSIDE CORNER FASCIA BRACKET MOUNTING DETAIL

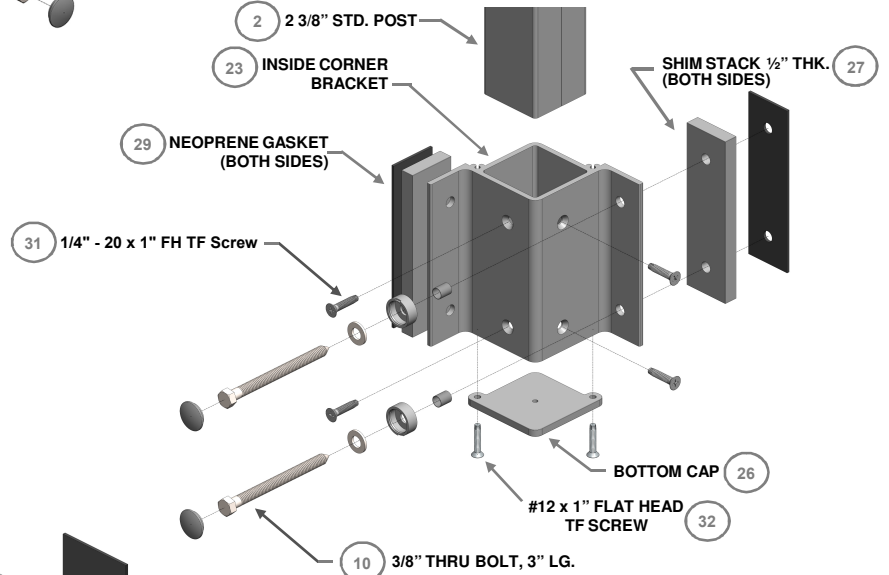

B OUTSIDE CORNER FASCIA BRACKET MOUNTING DETAIL

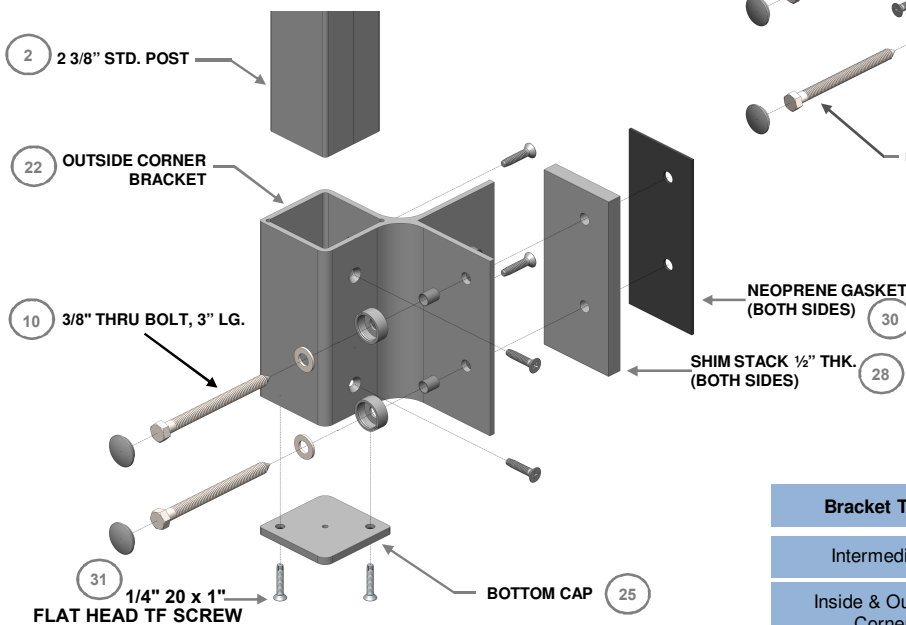

Mounting Bolts/Lag Screws

Bracket Type	Wood	Concrete
Intermediate	STD-AC-05	STD-AC-06
Inside & Outside Corner	STD-AC-08	STD-AC-07

Installation Instructions For eGlass® Vision™

INTERMEDIATE FASCIA BRACKET

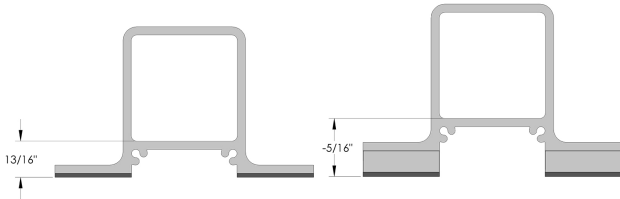

OUTSIDE CORNER FB

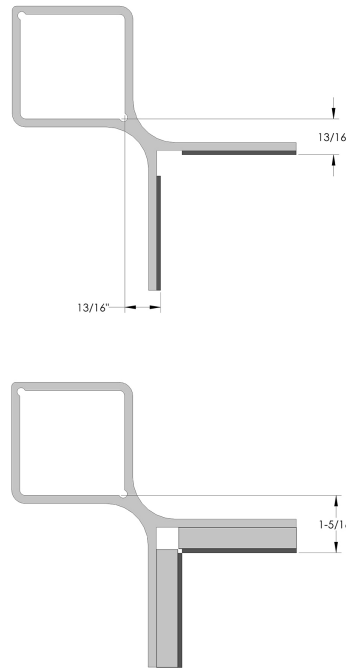

STANDARD SQUARE POST

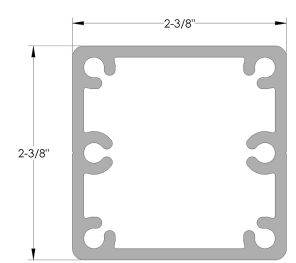

INSIDE CORNER FASCIA BRACKET

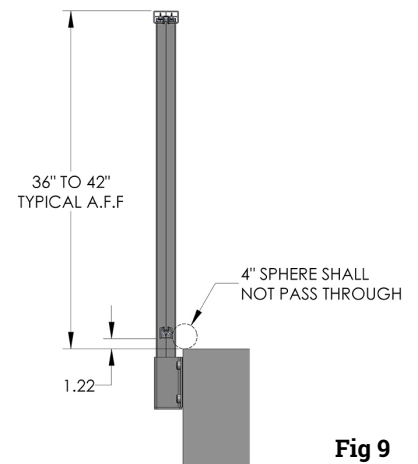
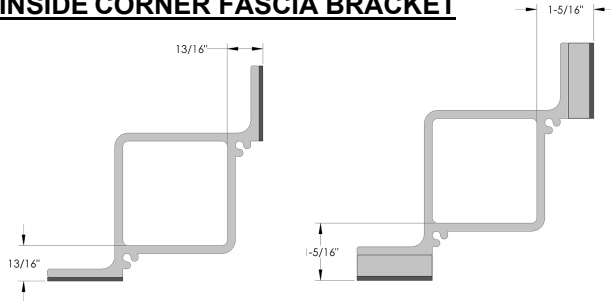

5C. Measure & Cut Posts

- Select a post blank (2) and insert into fascia bracket (Fig 7)
- Line up the bottom of the post with the bottom of the bracket.
- Secure flat head TF screws (31) through fascia bracket holes into post (Fig 7). Hold post plumb while screwing into place.
- Vary fascia bracket bolt torque to further plumb post.
- Use the fascia mount drill card (for inline posts) or reference your Customer Detail Form (for stair posts) to measure and mark a cut line towards the top of the post. (Fig 10)
- Remove post from bracket and cut according to marking.
- After cutting, measure the length of your post and cut all other posts to the same length.
- Use touch-up paint to coat exposed aluminum.

Fig 9

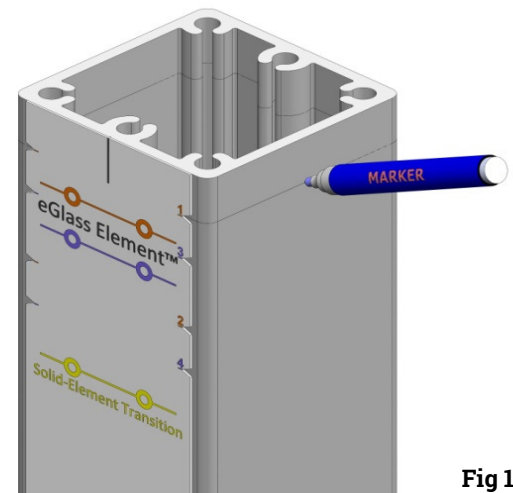

Fig 10

5D. Install Posts

- Install all posts into their brackets and secure them using the provided screws (31)
- Screw bottom plates (24, 25, 26) into post or fascia bracket (Fig 7) using the appropriate screws (31, 32).
- Plumb posts as needed by varying fascia bracket bolt torque. Make sure posts and brackets are fully plumb to ensure proper top rail installation.

Installation Instructions For eGlass® Vision™

Step 6: Pre-Drill Clamp Locations

- Place the drill guide (15) on the post. Place the end that says "DECK SURFACE" as shown in figure 11. Tape the Drill Guide to the post using painter's tape.
- Use the Drill Guide to ensure the glass clamp locations are lined up correctly.
- Use the center punch to mark the glass clamp holes. Be sure to make a large mark to ensure the drill remains centered.
NOTE: Deck mount glass clamp drill hole locations are noted in **Blue**. Fascia Mount noted in **Red**.
- Use the Clamp Installation Kit (12) to pre-drill the holes in the post (2) for the glass clamps as indicated by the drill guide marking.
- Use touch-up paint to paint the drilled holes to protect from corrosion.

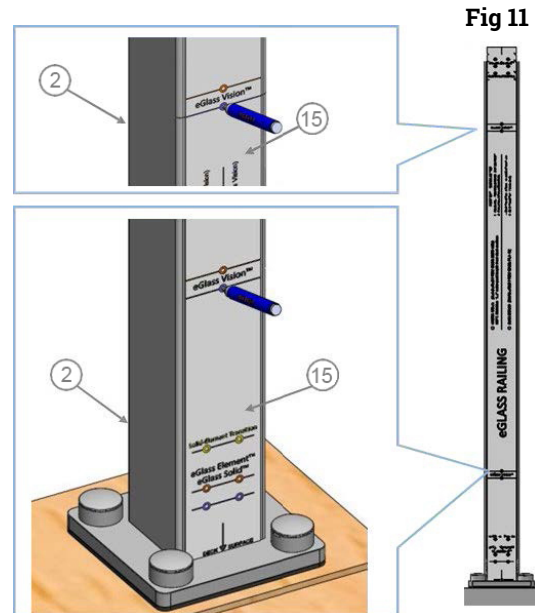

Step 7: Attach Clamps to Posts

- Disassemble the glass clamps (6 or 7) by unscrewing the two Allen head clamping screws (9).
- Place the male part of the glass clamp (6 or 7) over a pre-drilled hole on a post and secure to post using a 1/4" - 20 x 1" Phil Pan TYF 410SS screw (8)
- Do not over tighten.

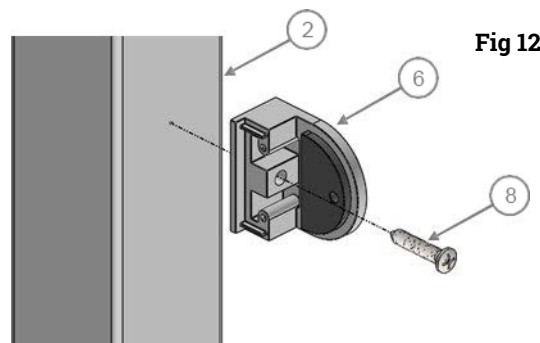

Step 8: Install Glass Panels

- Insert rubber gaskets into both sides of the glass clamp (6 or 7). For eGlass Stock Panels, use 9.52mm gaskets. For custom glass, start with 8.76mm gaskets and swap out with thicker gaskets on one or both sides as needed for a snug fit.
- Have someone hold a glass panel (1) in place against the male part of the glass clamps (6 or 7) while the female sides of the glass clamps are installed using the two socket head cap screws (9) provided with each clamp.

NOTE: You may want to stack two 2x8 boards onto the deck surface between the posts to provide a level, elevated surface that will support the glass panels during clamp installation.

- Use the level gauge to ensure the glass panel (1) is level.
- Make sure the glass panel (1) is supported firmly by the glass clamps (6 or 7). Do not over tighten.

Note: Maintain gap of no more than 4" between deck and bottom rail.

Repeat Steps 6-8 for all posts.

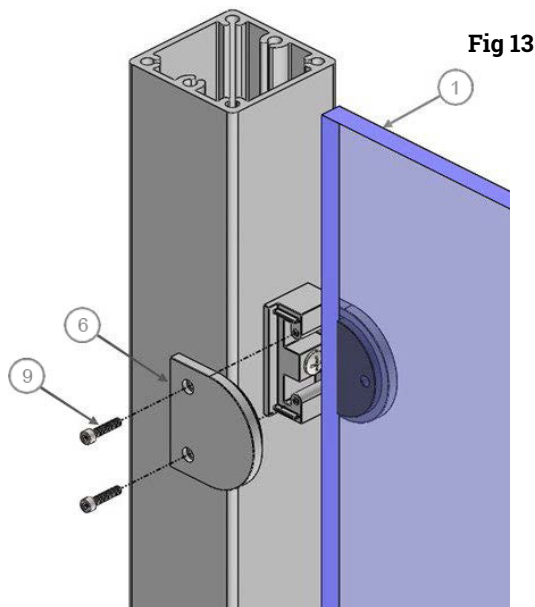

Installation Instructions For eGlass® Vision™

Step 9: Drill Weep Holes For Deck Mount Posts (SKIP IF SYSTEM IS FASCIA ONLY)

- Make a mark for the weep hole at the deck side center of post.
- Drill weep hole.
- Use touch-up paint to paint the weep hole to protect from corrosion.

Repeat Step 9 for all posts

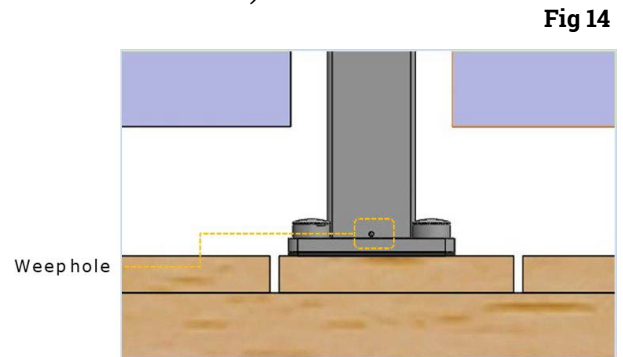

Fig 14

Step 10: Install Post Caps

- Line up post cap (4) on post (2), then press cap onto post.
- Snap on bolt caps (14D).
- If cap does not fully seat, place a clean cloth over the cap and tap into place with a dead blow hammer.

Repeat Step 10 for all posts

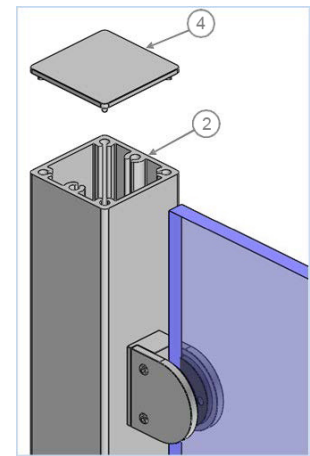

Fig 15

Step 11: Care & Maintenance

- Gently wash with a clean, microfiber (lint free) cloth and a mild detergent (like dish soap) followed by a clear water rinse. Glass can be wiped with a squeegee, if necessary.
- Avoid contact with nail polish remover, paint or lacquer thinner, motor oils, transmission and brake fluids or other solvent-based cleaning fluids. If any of these products contacts the powder coated surface, immediately wipe the area with a soft, clean cloth, and wash as described above.

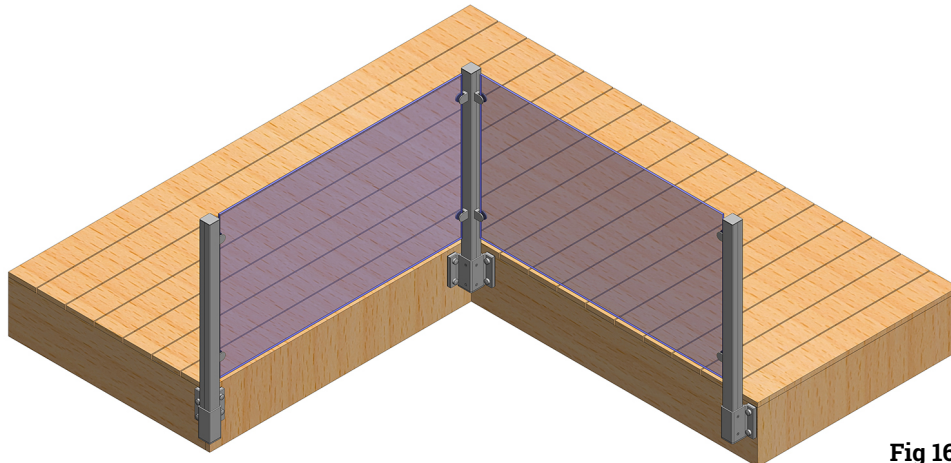

Fig 16